

GENERAL PUMP *A member of the Interpump Group*

2100357

Industrial Hose Reel

SPECIFICATIONS

PART NUMBER	2100357
3/8" Hose Capacity	100 ft.
1/4" Hose Capacity	150 ft
Swivel Pressure Rating	5,000 PSI
Inlet	3/8" NPT-M
Outlet	3/8" NPT-F
Max. Temp	185° F

FEATURES / BENEFITS

- Direct hand-crank rewind with locking pin
- Solid steel construction
- Durable powdercoated finish (Reel)
- Galvanized base

PARTS LIST

Item	Part No.	Description	QTY
1	2103112	ASSY, BASE	1
2	2660216	HANDLE	1
3	2701052	FOOT	4
4	2200018	WASHER, M6	8
5	2200026	NUT, NYLOK, M6	4
6	2200091	BOLT, HHCS,M6	4
7	2103111	REEL, HOSE	1
8	100056	HANDLE, ASSY	1
9	2103051	SWIVEL, HOSE REEL	1
10	2103110	ASSEMBLY, HOSE	1
11	D10121	FTG, 3/8 NPT-F x 1/4"	1
2100278		Repair Kit for 2103051	

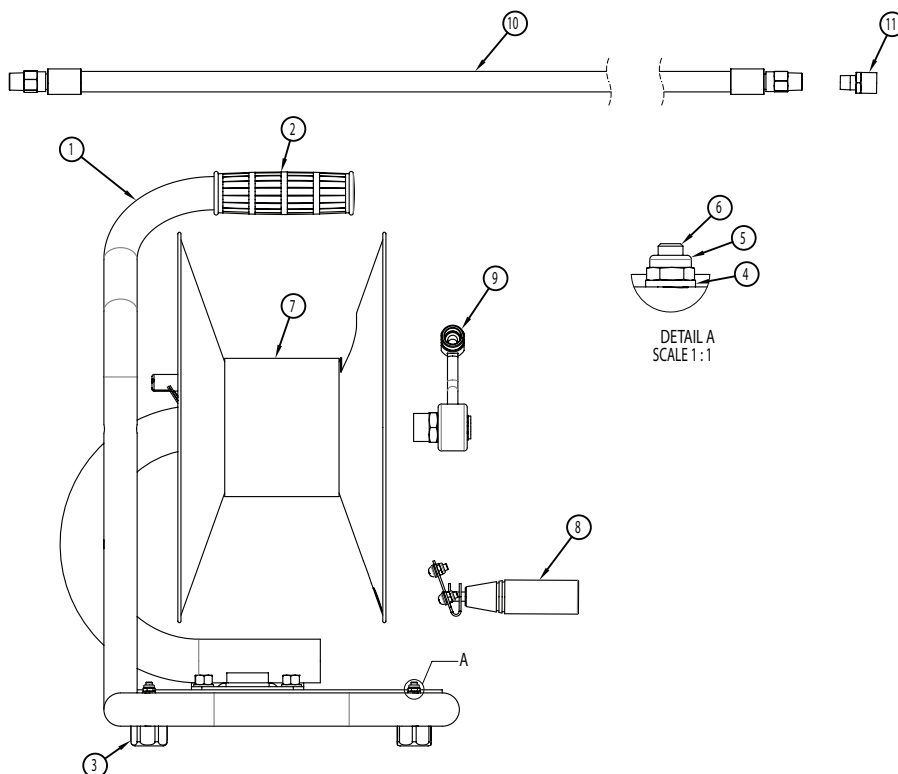

DIMENSIONS

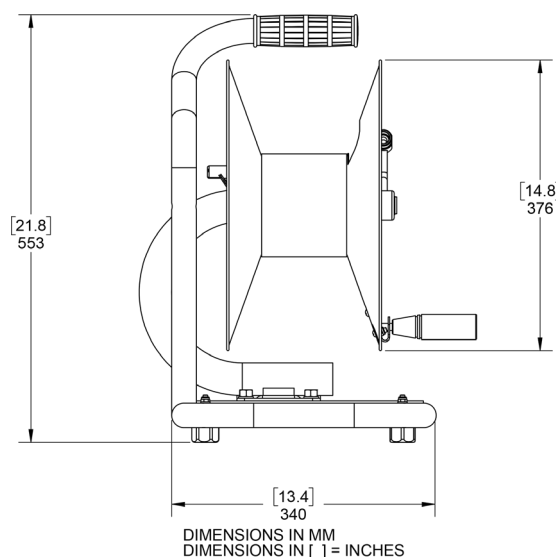

ASSEMBLY INSTRUCTIONS

1. Clamp the hardware kit to the hose reel handle with the two M8 bolts. Secure it from rotating or slipping with the M6 bolt.
2. Use thread sealant (not provided) and the supplied fittings/adapters as needed to connect an inlet hose (not provided) to the hardware kit inlet.
3. Use thread sealant on the hose reel pigtail and connect to the hardware kit outlet.
4. The hardware kit may be used to turn flow on or off to the hose reel and to monitor pressure and flow in the hose reel.
5. Two different length U-bolts are supplied with the hardware kit for attaching the hose reel as needed to a truck or cart.

OPTIONAL ACCESSORIES



- Glycerin Filled Gauge
- Full Flow Ball Valve
- 5000 PSI
- 1/4" NPT-F Inlet
- 1/4" NPT-F Outlet

PRESSURE DROP: HOSE REEL & KIT, 2100357 & 2100358

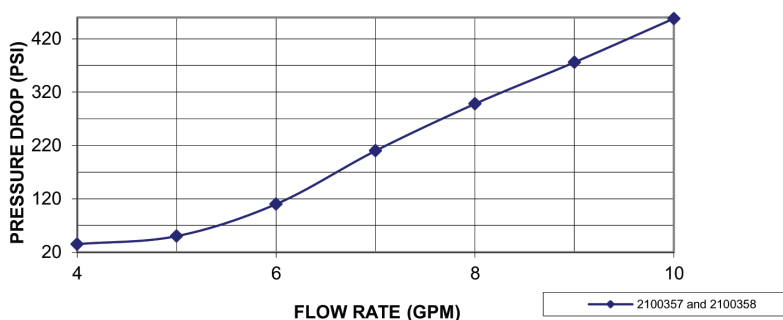

**NOTE: 2100358 is an optional hardware kit.

SAFETY PRECAUTIONS

1. Make sure incoming pressure does not exceed the rated pressure.
2. Use proper eye protection when assembling and using the hose reel.
3. Assemble the hose reel on a clean workbench free of debris and moisture.
4. Use soap and water when checking for air leaks.
5. Keep children away from work area.

WARNING!

Exposure of skin directly to pressurized air or fluids could result in severe bodily injury!